

VER	DATE	UPDATE	APP'D
A	2011/01/31	release	JSL

19" Vertical PDU w/10 AC Outlets

Part Number.....	HPS-E10A
Mounting.....	Horizontal
AC Rating Volts.....	120Vac
AC Rating Amps.....	12Amp
AC Rating Watts.....	1440W
AC Rating Frequency-Hz.....	60 HZ
Switch With Circuit Breaker.....	15A
Surge Level.....	A3 (Including EMI Protection)
Joule Rating.....	1050J
Surge Indicator.....	Green LED
Power Cable AWG.....	14/3 SJT
Power Cable Length.....	6 ft
Power Indicator.....	Red LED
Plug Type.....	NEMA 5-15P
Receptacle Type.....	NEMA 5-15R
Replaceable Quantity.....	10
Max Output Per Outlet.....	12Amp
UL Rating.....	60950-1
Certification/Agency Approvals.....	UL

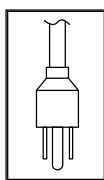

NEMA 5-15P 15A/120V MOLDED DN PLUG

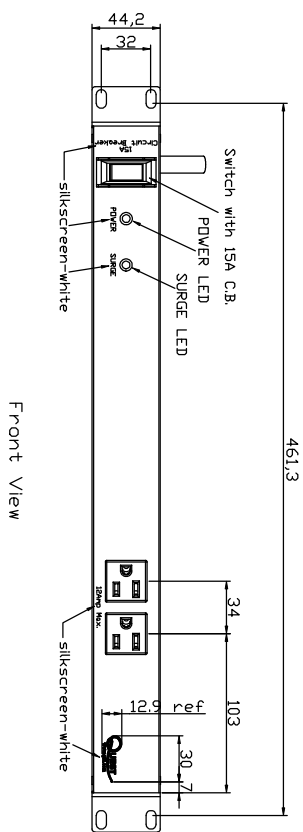
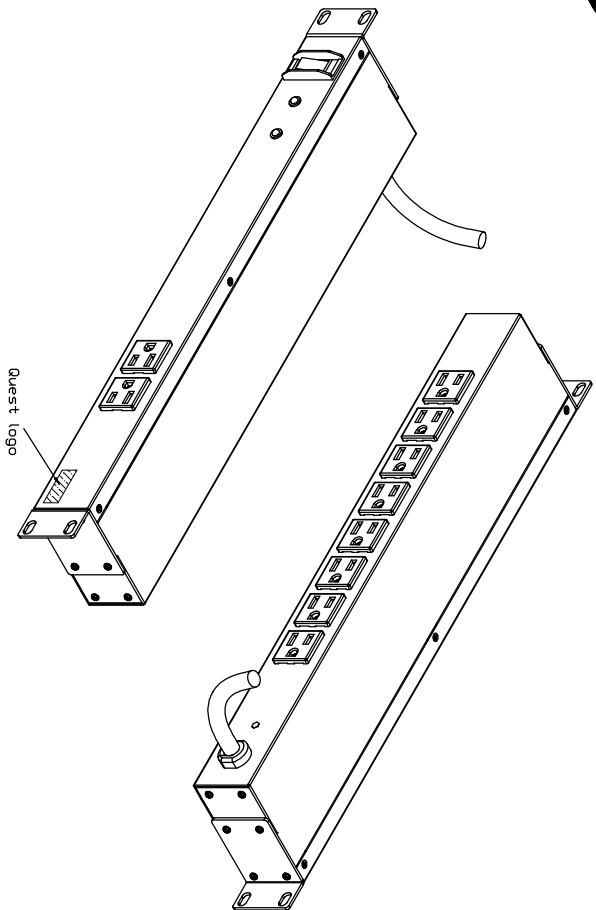
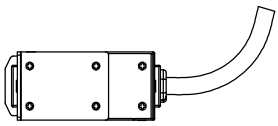
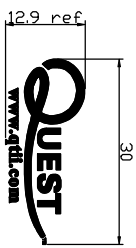
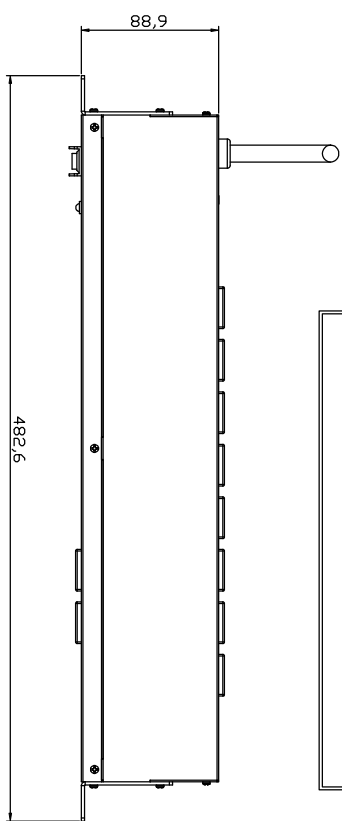

Front View

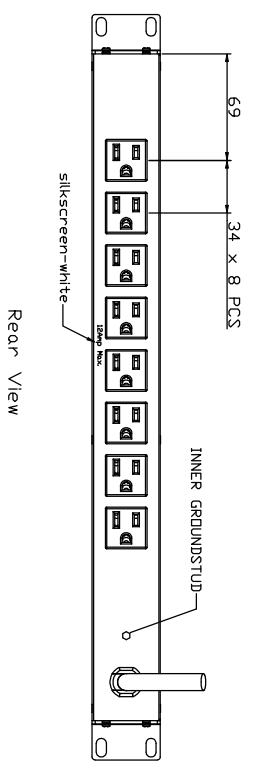

Rear View

NAME	DATE	DIMENSION TOLERANCE	MATERIAL	QUEST	SYMBOL
DRAWN	VNC	2011/01/31	SECC	HPS-E10A with silkScreen	
CHECKED	TYC	2011/01/31			
APP'D	JSL	2011/01/31			

SCALE: 1:2 | VERSION: A

