

Cleerline SSF™ SC Connector

Termination With:
SSF™ Jacketed Fiber 2.0mm / 3.0mm

This guide assumes proper selection of connector matching cable type. Due to SSF™ fiber's extreme durability your cleaver may require a wheel height adjustment to successfully cleave SSF™²

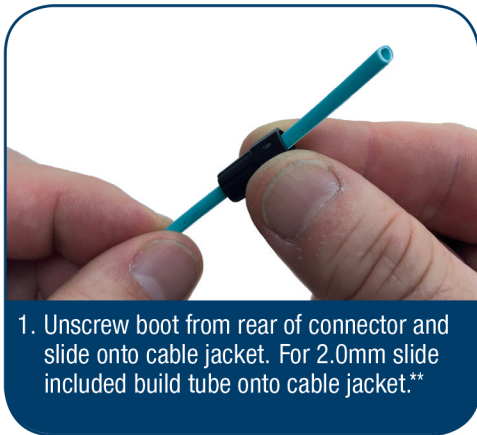
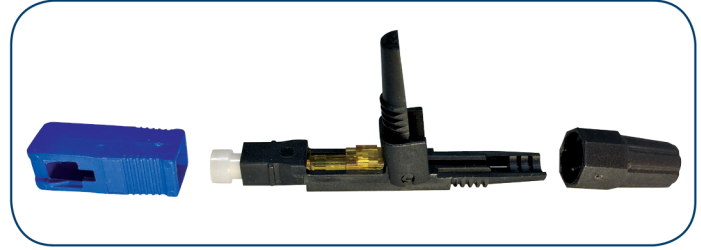
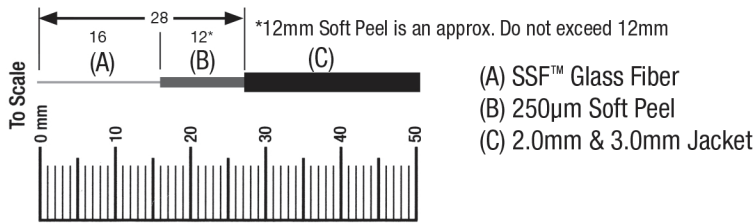

1. Unscrew boot from rear of connector and slide onto cable jacket. For 2.0mm slide included build tube onto cable jacket.**

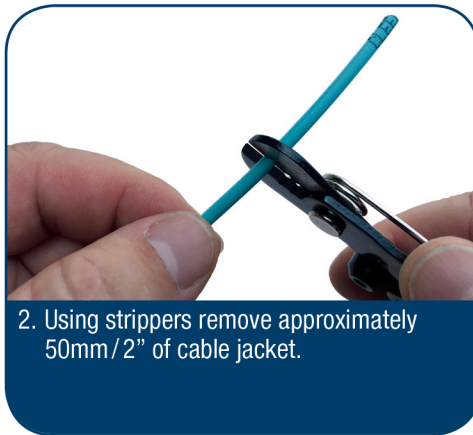

2. Using strippers remove approximately 50mm / 2" of cable jacket.



3. Place onto VFL. Ensure activator slide tab is in "open" position - slide towards rear of connector. Open hinge on connector.



4. Pull Kevlar yarns back to locate SSF™ fiber. Use only finger tips/nails to gently remove "Soft Peel" 250µm coating to within 12mm / 1/2" of cable jacket.¹

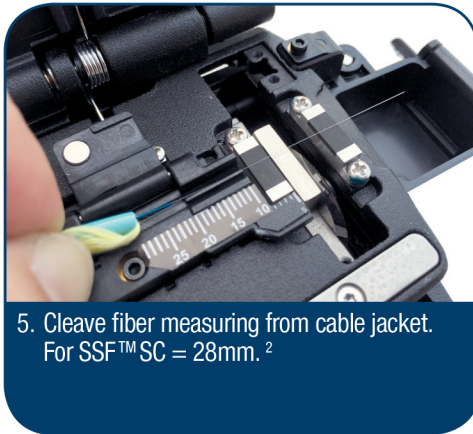

5. Cleave fiber measuring from cable jacket. For SSF™ SC = 28mm.²

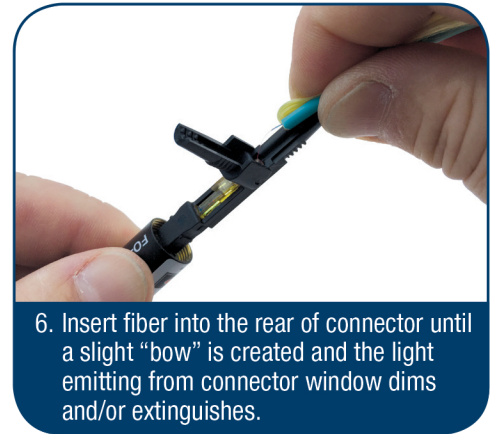

6. Insert fiber into the rear of connector until a slight "bow" is created and the light emitting from connector window dims and/or extinguishes.

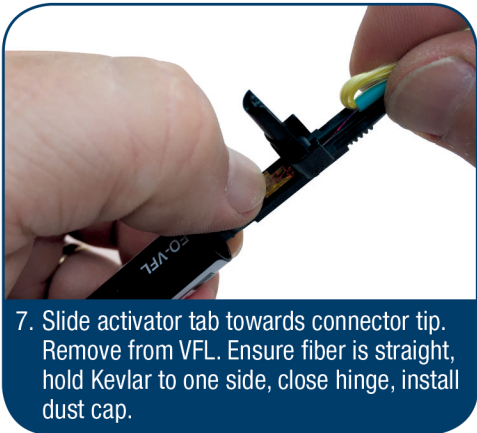

7. Slide activator tab towards connector tip. Remove from VFL. Ensure fiber is straight, hold Kevlar to one side, close hinge, install dust cap.



8. Slide boot forward and thread one full turn to "lock in" Kevlar strands. Cut Kevlar close to boot. Tighten boot until secure. Install connector cover.

For more information
visit cleerlinefiber.com

**Termination on 250µm fiber (no jacketing or fan-out tube): Utilize part number SSF-250BT-10 build-up tubes for proper connector installation. View instructions and video at cleerlinefiber.com/resources

Termination of Standard, Non-SSF™ Fiber:
Termination of standard fiber requires different fiber preparation steps. Refer to the manufacturer's instructions or visit cleerlinefiber.com/resources for more information.

¹ SSF™ Fiber does not require the use of alcohol cleaning as the glass fiber is not exposed being protected with SSF™ proprietary coating. Remove the soft peel coating completely from all sides of the fiber with fingers only. Do not use strippers.

² Due to the extreme durability and bend insensitivity of SSF™ fiber your cleaver may require a wheel height adjustment procedure to allow successful cleaving of SSF™ fibers. For more information visit cleerlinefiber.com

Cleerline SSF™ SC Connector

Termination With:
SSF™ Fiber & 900µm fan out kit/tubing

This guide assumes proper selection of connector matching cable type and correct installation of 900µm fan out kit. Due to SSF™ fiber's extreme durability your cleaver may require a wheel height adjustment to successfully cleave SSF™²

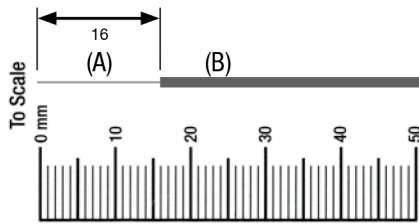

(A) SSF™ Glass Fiber
(B) 900µm Fan Tubing

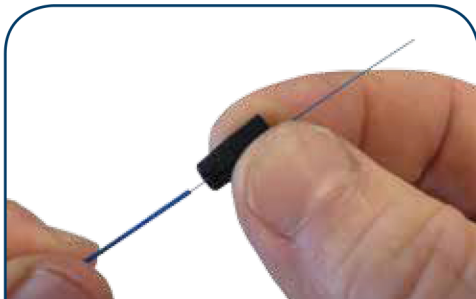
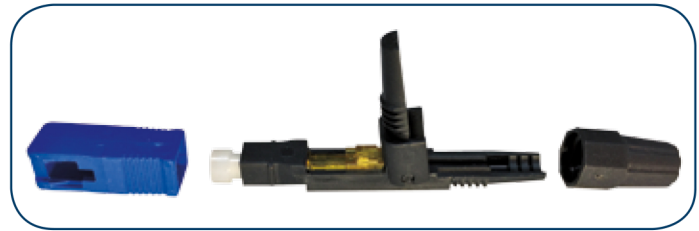

1. Ensure a minimum of 50mm of fiber exits the fan tubing. Unscrew boot from rear of connector and slide onto fan tubing.



2. Slide included 900µm build tube section onto fan tubing.**



3. Place connector onto VFL. Ensure activator slide tab is in "open" position - slide towards rear of connector. Open hinge on connector.

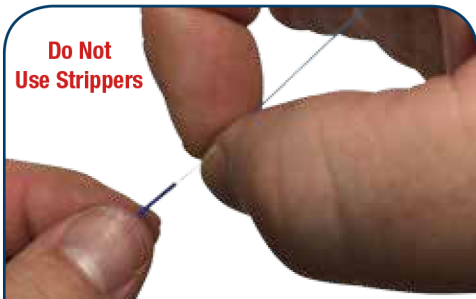

Do Not Use Strippers

4. Use only finger tips/nails to gently remove "Soft Peel" 250µm coating completely to fan tubing.¹

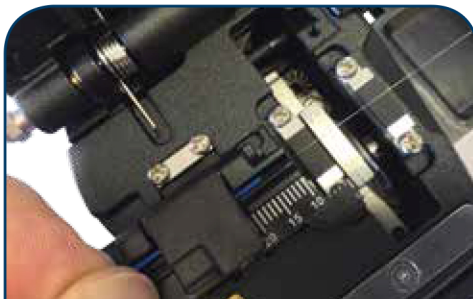

5. Cleave fiber measuring from fan tubing. For SSF™ SC = 16mm.²

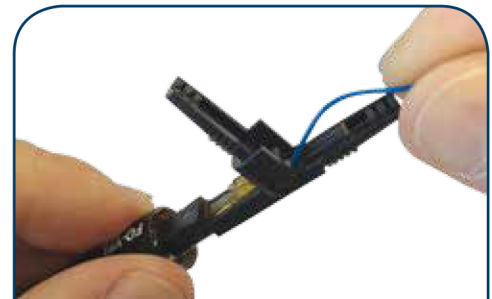

6. Insert fiber into the rear of connector until a slight "bow" is created and the light emitting from connector window dims and/or extinguishes.

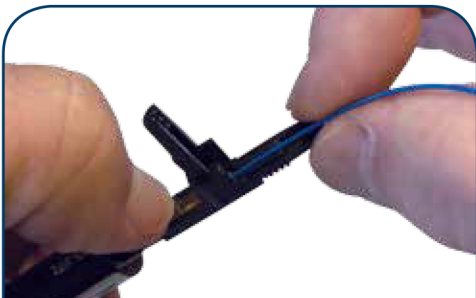

7. Slide activator tab towards connector tip. Remove from VFL, Install dust cap.



8. Slide build tube forward and seat in rear of connector, ensure fiber is straight, close hinge. Slide boot forward and tighten until secure. Install cover.

For more information visit cleerlinefiber.com

**Termination on 250µm fiber (no jacketing or fan-out tube): Utilize part number SSF-250BT-10 build-up tubes for proper connector installation. View instructions and video at cleerlinefiber.com/resources

Termination of Standard, Non-SSF™ Fiber:
Termination of standard fiber requires different fiber preparation steps. Refer to the manufacturer's instructions or visit cleerlinefiber.com/resources for more information.

¹ SSF™ Fiber does not require the use of alcohol cleaning as the glass fiber is not exposed being protected with SSF™ proprietary coating. Remove the soft peel coating completely from all sides of the fiber with fingers only. Do not use strippers.

² Due to the extreme durability and bend insensitivity of SSF™ fiber your cleaver may require a wheel height adjustment procedure to allow successful cleaving of SSF™ fibers. For more information visit cleerlinefiber.com