

## Download the App

The **My Leviton** app is available on Google Play and iTunes. Download the correct version for your mobile device

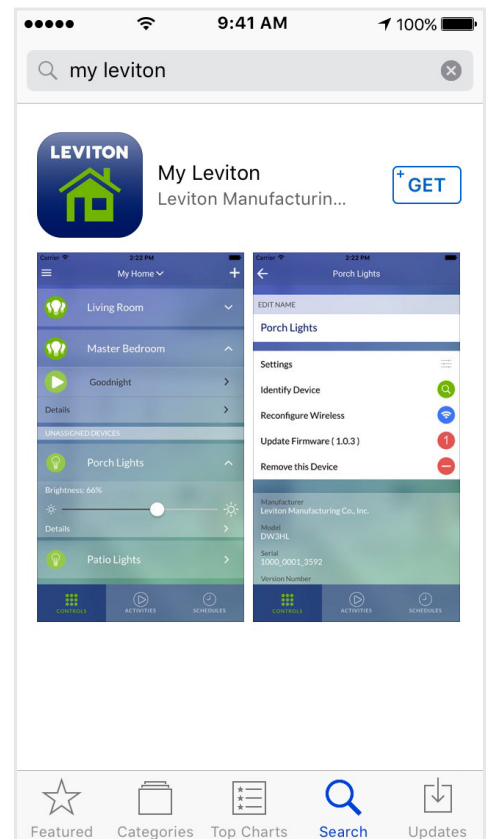

## Adding a Residence

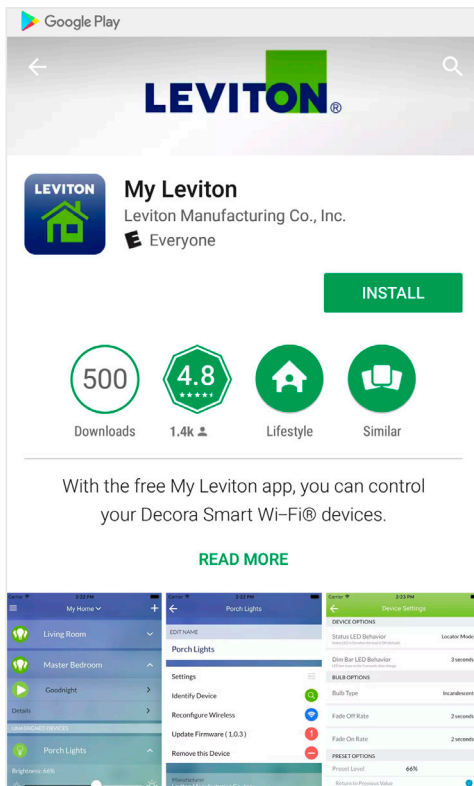
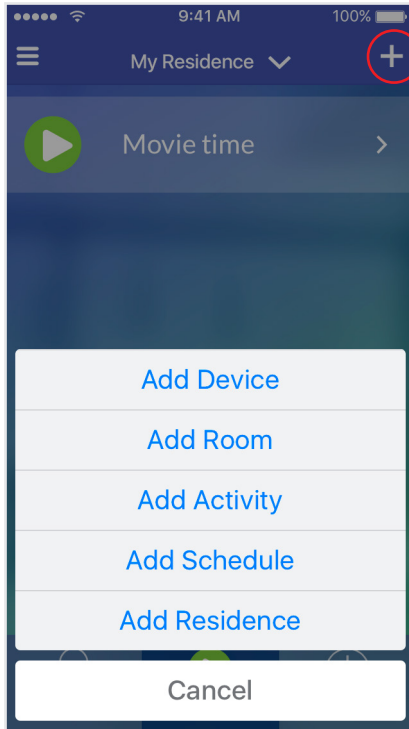

To add a new Residence, tap (+) and select **Add Residence** from the list.

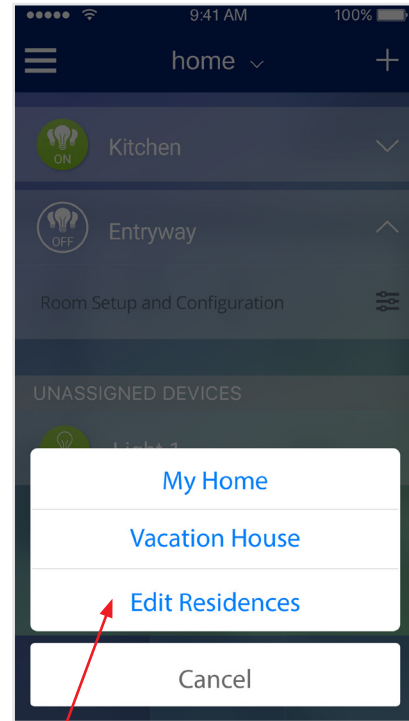

To edit an existing residence, click **Edit Residences** from the list.

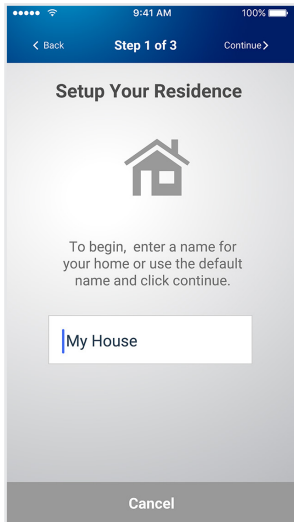

Follow the steps to create a new Residence.

You can rename the residence, change or remove the address, or delete the residence from this screen.

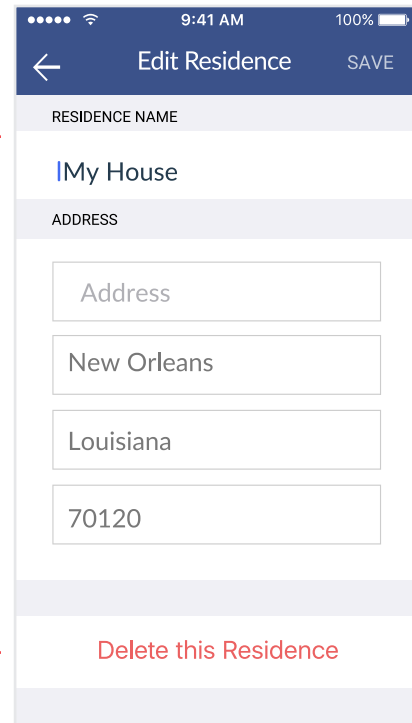

## Adding a Device

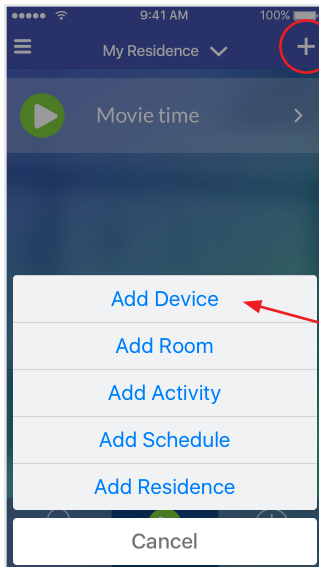

To add a new device, click (+) and select **Add Device** from the list.

Tap **Add Device** to start the process.

Once added, your Leviton devices are available to a room.

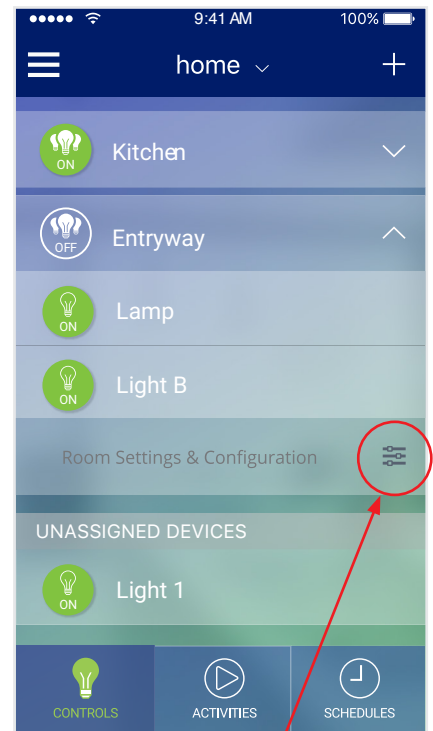

Follow the steps to set up your device. You will first connect to your new device and then connect to your home network.

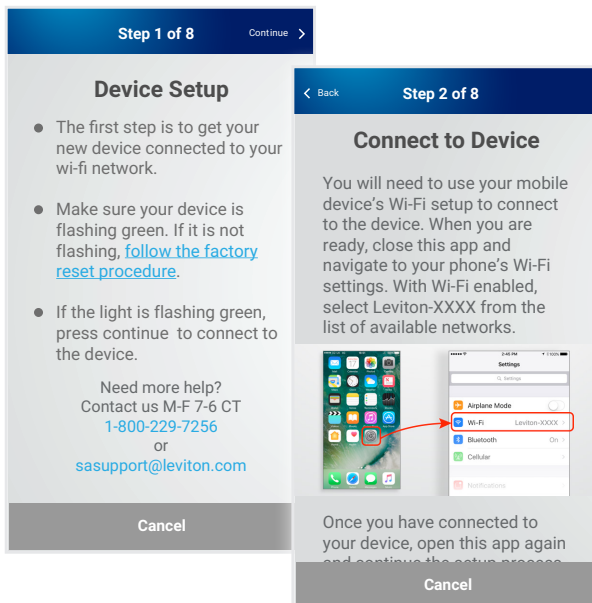

Access the room settings page by tapping on **Room Configuration**.

This is where you can assign your new devices to the room.

## Adding an Activity

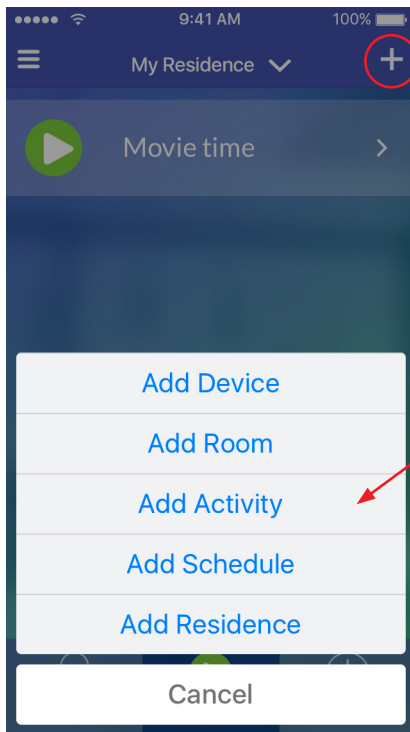

To add an activity, click (+) and select **Add Activity** from the list.

Tap to add an Activity.

Name your new Activity.

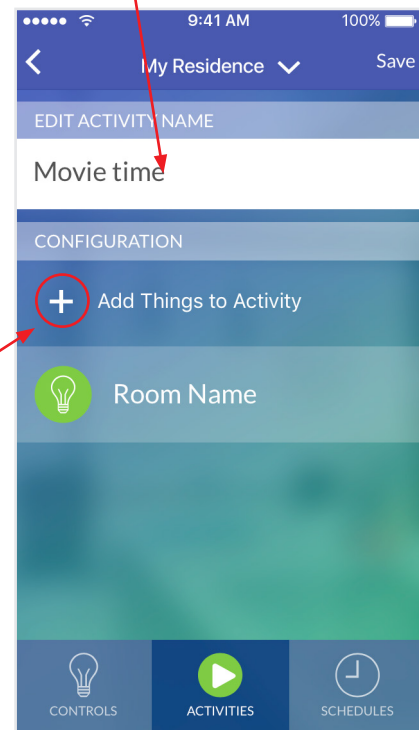

Add room commands or device commands to your activity.

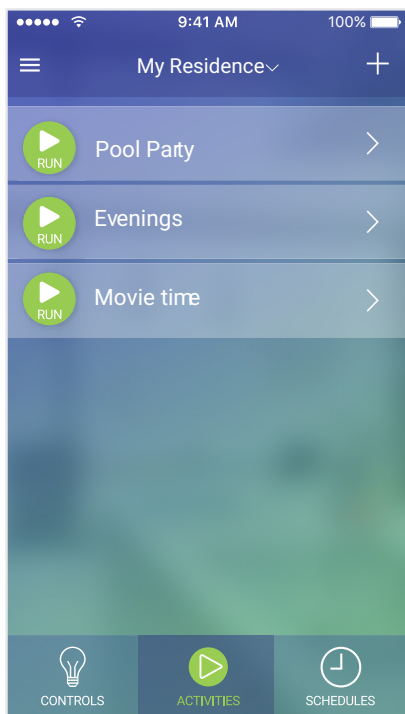

New activities are added to the activities list, where they can be run.

From this page, activities can be edited or deleted.

## Adding a Schedule

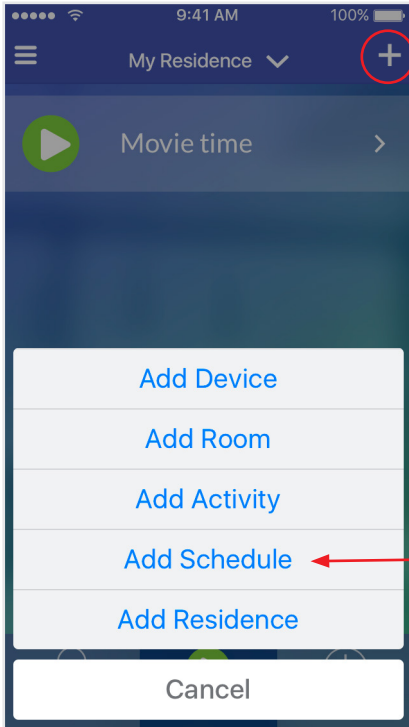

To add a new Schedule, click (+) and select **Add Schedule** from the list.

Tap to add a Schedule.

Schedules can be turned on and off from the Schedules screen.

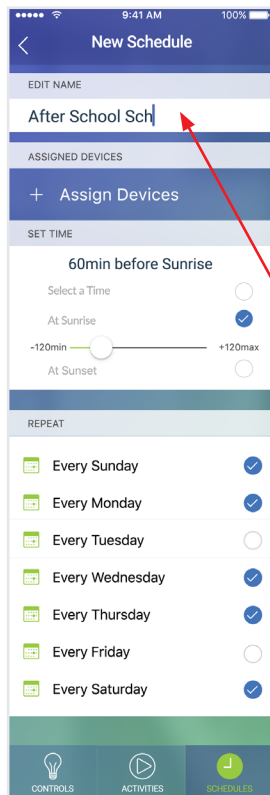
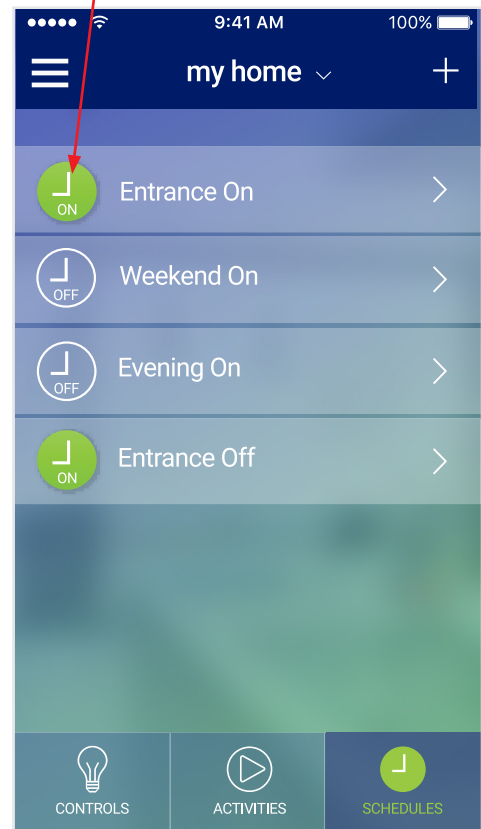

Name the new schedule, assign devices, and set the time and frequency.