

RACK BASICS®

Wall-mounted Cabinet (Single Section) Assembly Manual

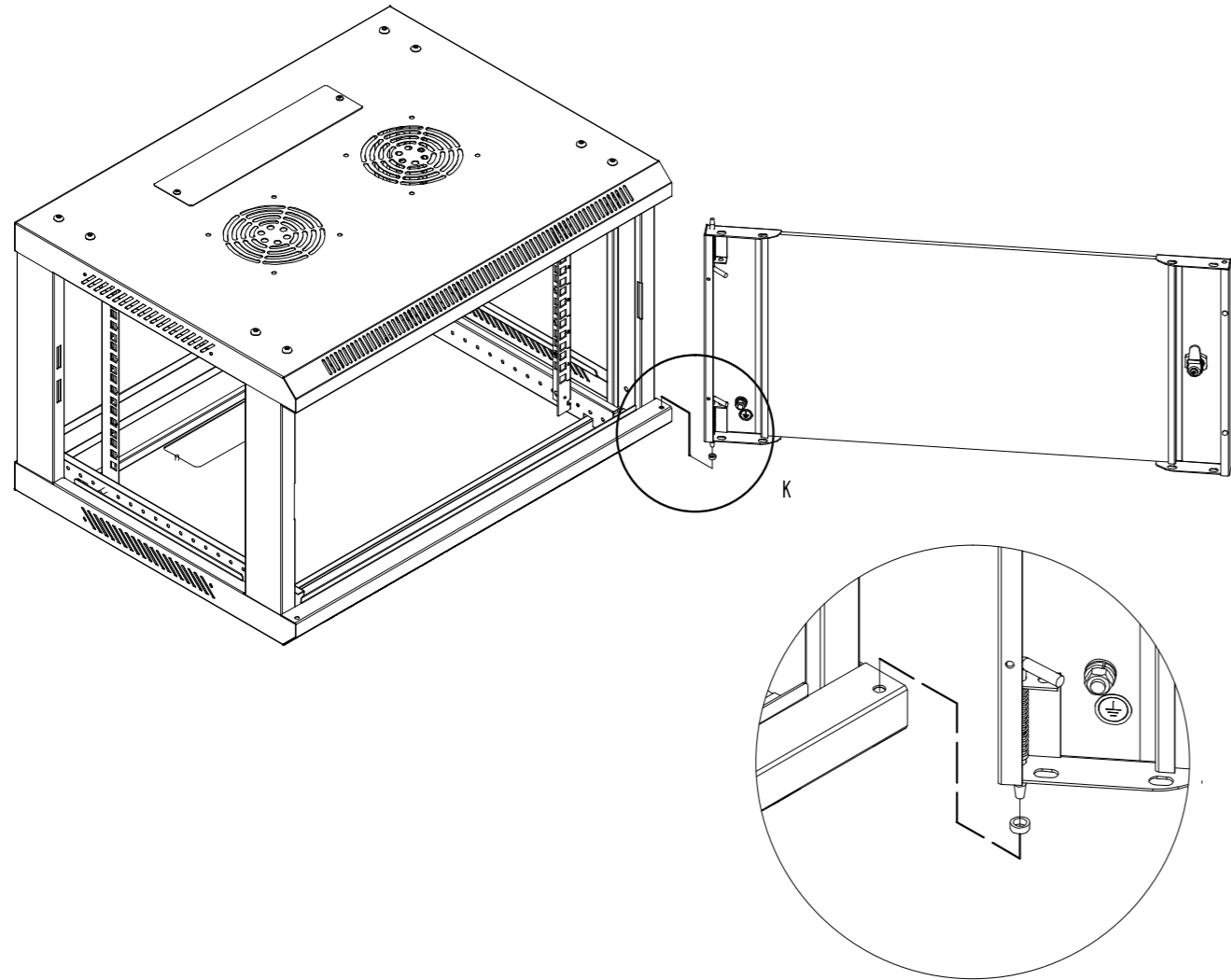

The local view K
Proportion 2:1

(5) Assembly the front door with 1pcs white plastic washer and bolt. And toolless assembly the side doors.

Note:After assembly,please adjust the diagonal size of the cabinet to ensure homogeneous space for all doors and all doors work well.

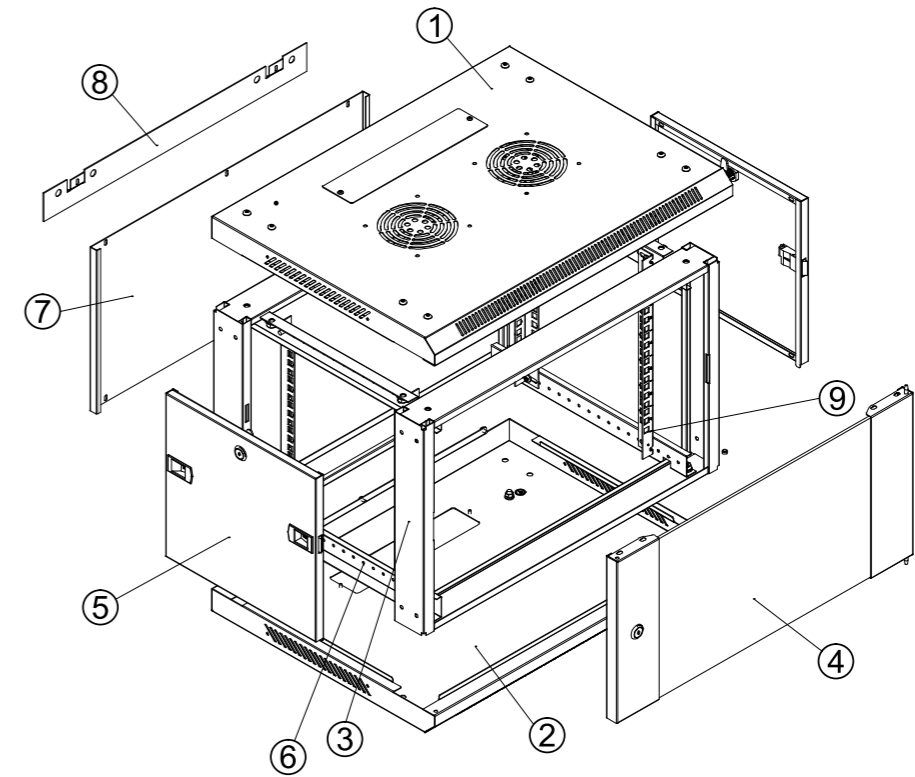

Packaging List

- | | |
|-----------------------|-----------------------------------|
| 1. Top panel- 1pcs | 6. Horizontal Beams- 4pcs |
| 2. Bottom Panel- 1pcs | 7. Back Panel - 1pcs |
| 3. Frames- 2pcs | 8. Mounting Bracket - 1pcs |
| 4. Front Door - 1pcs | 9. Vertical Mounting Rails - 4pcs |
| 5. Side Panels- 2pcs | |

Item List of Accessories Packaging

- Assembly Hardwares Kits:
- | | |
|--------------------------------------|--------------------------------|
| A. M8*12 Inner Hexagon Screw - 16pcs | E. White Plastic Washer - 1pcs |
| B. M8 Flange Nut - 16pcs | F. Keys-2pcs |
| C. M5*10 self tapping screws -8pcs | |
| D. M4*8 Self-tapping Screw - 12pcs | |
- End User Hardwares Kits:
20 sets M6 Cagenuts.

Tips: Check the quantities of the items before assembly.

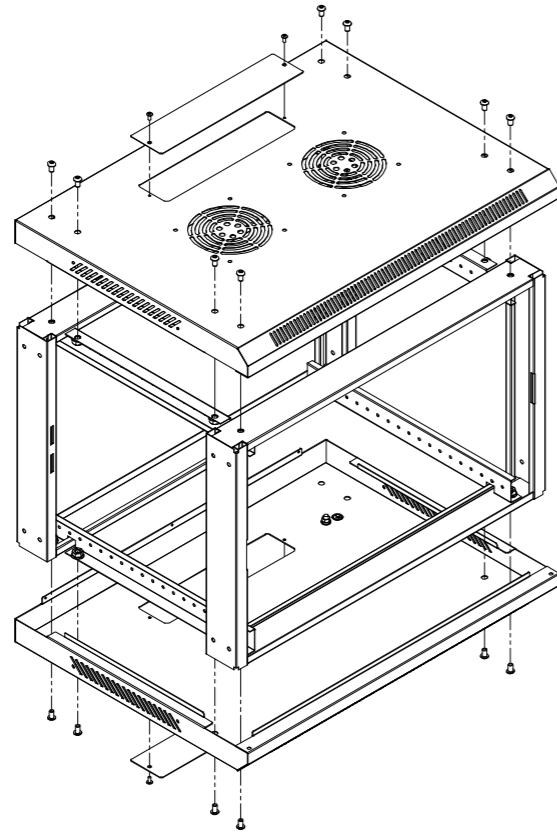

(1) Assembly the top panel, frames and horizontal beams by 16pcs M8*12 inner hexagon screws and 16pcs M8 flange nuts.

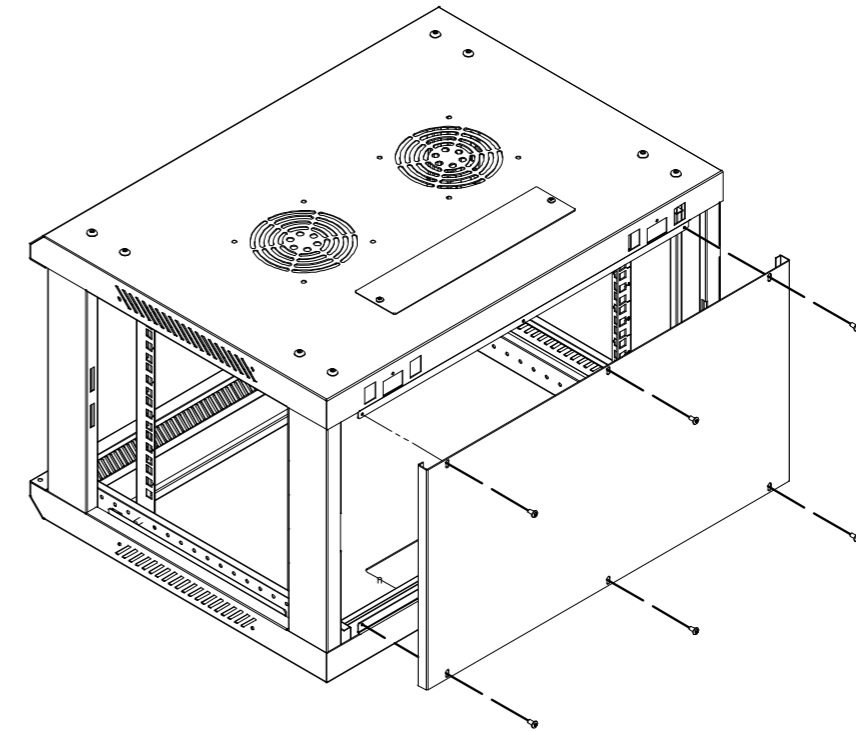

(3) Assembly the back panel by 6pcs M4*8 self- tapping screws.

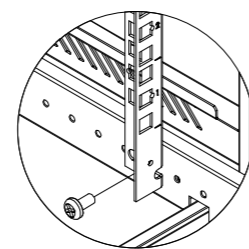
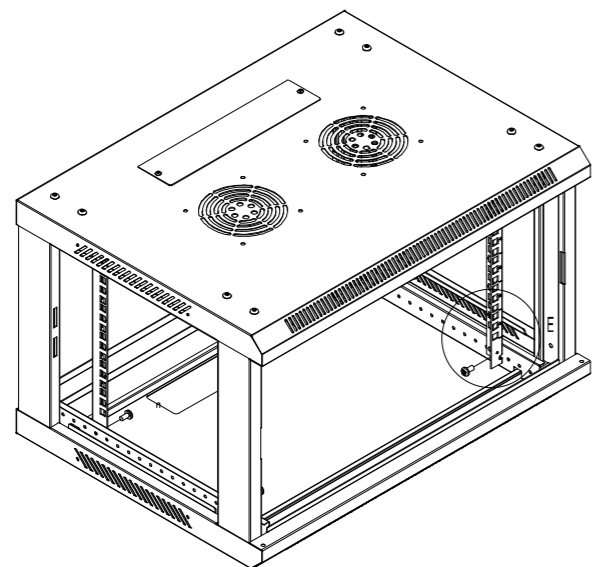

The local view E
Proportion 2:1

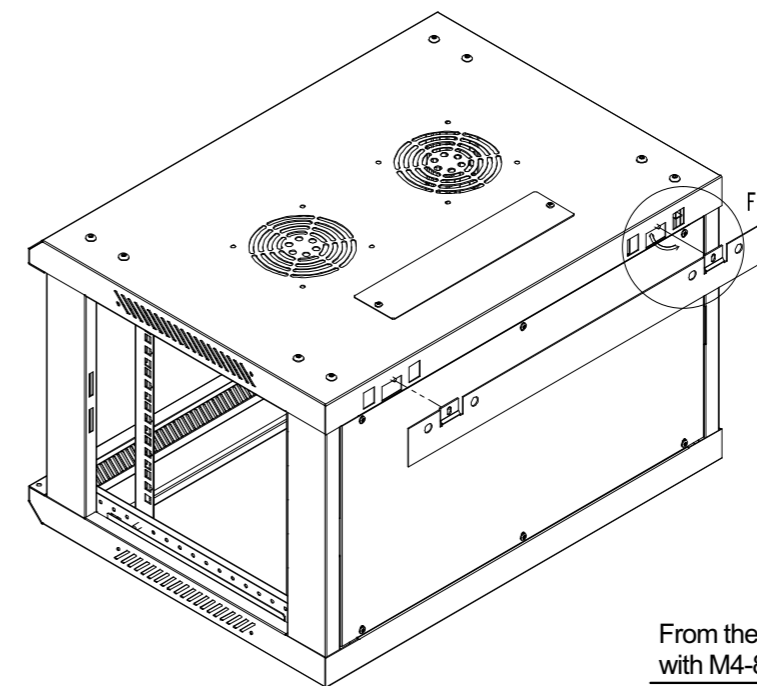

From the medial penetration
with M4-8 screws

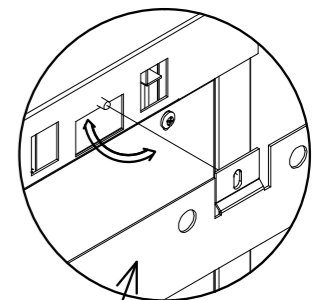

The local view F
Proportion 2:1

(2) Assembly the horizontal beams by 8pcs M5*10 self tapping screws.

(4) Assembly the mounting bracket by 2pcs M4*8 selftapping screws.