



Blank Wall Mount Fiber Patch Panel, Compact Indoor with 1 Splice Holder, Up to 12 Fibers

FB36-4296WM

This compact indoor wall mount fiber enclosure is for inter-connectivity and termination of optical fibers with the capacity of one adapter panel and comes with an integrated single splice holder that can accommodate 12 single fusion splices. Its small size is ideal for use in tight closets, inside cabinets and enclosures, and DOT Traffic Control enclosures. Black.

Features

- 1 Adapter panel capacity
- Compact design for small spaces
- Integrated splice holder
- Holds up to 12 single fiber fusion splices
- This fiber wall mount enclosure is only compatible with our FB24 adapter panel inserts
- Comparable to Corning's SPH-01P
- Compatible with LGX adapter plates
- Ideal for data centers, premise installations, telecom networks and fiber networks, etc.
- Max density of 24f using an LC connection
- Wall-mountable
- Accepts loose tube & distribution cable
- Multiple adapter & splicing options
- Multiple fixing points
- Hinged door for easy access
- RoHS, REACH, and SVHC compliant

Mechanical Specifications

- Depth: 1.16"
- Length: 6.3"
- Width: 5.51"
- Weight: 2 lbs.
- Plate Thickness: 1mm
- Applicable temperature: -40°C to 60°C

Physical Characteristics

- Material: 18 Gauge Steel
- Color: Black
- Coating: Electrostatic Polyester Powder Coat
- Includes 4 Plastic Cable Ties
- Includes 4 Plastic Cable Labels

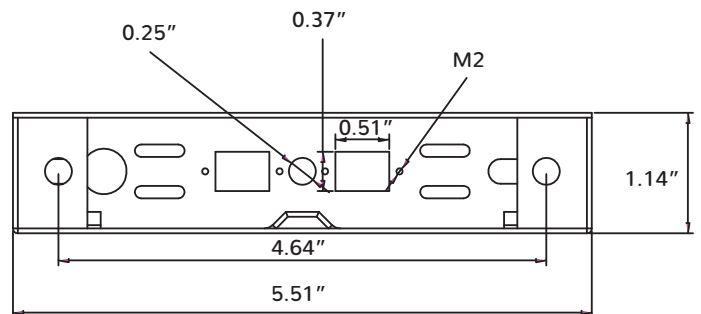
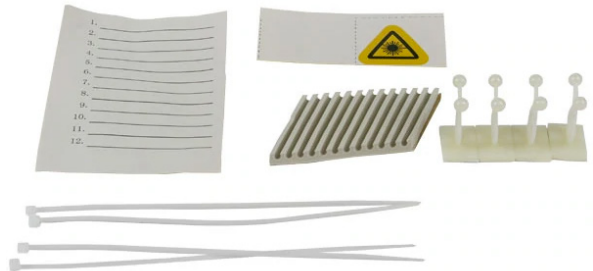

PrimusCable.com - (951) 824-1571



Blank Wall Mount Fiber Patch Panel, Compact Indoor with 1 Splice Holder, Up to 12 Fibers

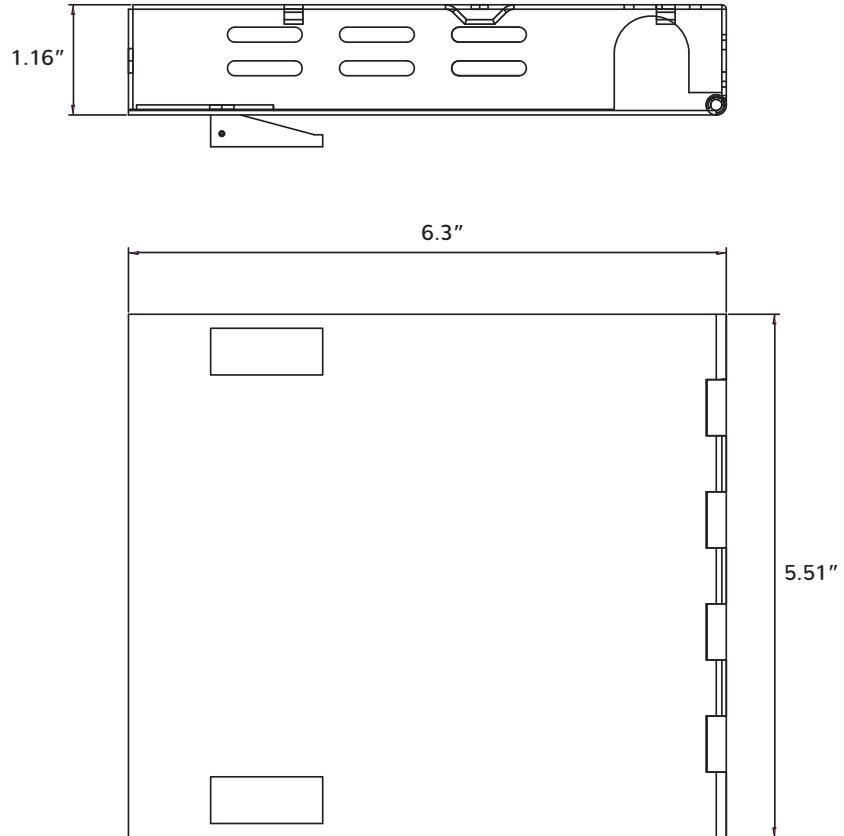

©2022 CRN Solutions Inc. dba. Primus Cable
All Rights Reserved.

Although Primus Cable makes every reasonable effort to ensure their accuracy at the time of this publication, information and specifications described herein are subject to error or omission and to change without notice, and the listing of such information and specifications does not ensure product availability.

Primus Cable provides the information and specifications herein on an "AS IS" basis, with no representations or warranties, whether express, statutory or implied. In no event will Primus Cable be liable for any damages (including consequential, indirect, incidental, special, punitive, or exemplary damages) whatsoever, even if Primus Cable has been advised of the possibility of such damages, whether in an action under contract, negligence or any other theory, arising out of or in connection with the use, or inability to use, the information or specifications described herein.

All sales of Primus Cable products are subject to Primus Cable's standard terms and conditions of sale.

Primus Cable believes this product to be in compliance with EU RoHS (Directive 2002/EC, 27 Jan. 2003). Material manufactured prior to the compliance date may be in stock at Primus Cable facilities and in our Distributor's inventory. The information provided in this Product Disclosure, and the identification of materials listed as reportable or restricted within the Product Disclosure, is correct to the best of Primus Cable's knowledge, information, and belief at the date any other operation of the product itself or the one that it becomes a part of. This Product Disclosure is not to be considered a warranty or quality specification and regulations based on their individual usage of the product.

Primus Cable declares this product to be in compliance with EU LVD (Low Voltage Directive 73/23/EEC), as amended by directive 93/68/EEC

PrimusCable.com - (951) 824-1571