

EXUSB3.0

USB 3.0/3.1/3.2 on category Cable 100M Extender Kit With FSYNC

The EXUSB3.0 can extend a USB 3.0 device up to 100m on category cable. The transfer data rate is up to 5Gbps. Other USB versions are also backwards compatible with this device (USB2.0 and USB1.1). The RX device has two USB-C and two USB Type-A ports. One each supports 1.5A of charging current while the other two support 1000mA (1 Amp). Hardware acceleration is supported for isochronous bulk data transfer, as is RS-232 pass-thru. FSYNC GPIO pass-thru is supported for camera synchronization. Power is applied on one end (either). Compact size makes placement of RX and TX easier in situations where space is limited.

SIMPLIFIED
MFG



Features:

- USB 3.2, 2.0, 1.1 support
- 4 Type A ports on RX end (two 1.5A, two 1.0A)
- Isochronous hardware acceleration
- RS-232 Pass-thru
- FSYNC GPIO
- Plug and Play
- Compact size for easy placement
- Powers one end (either)
- 3-year warranty

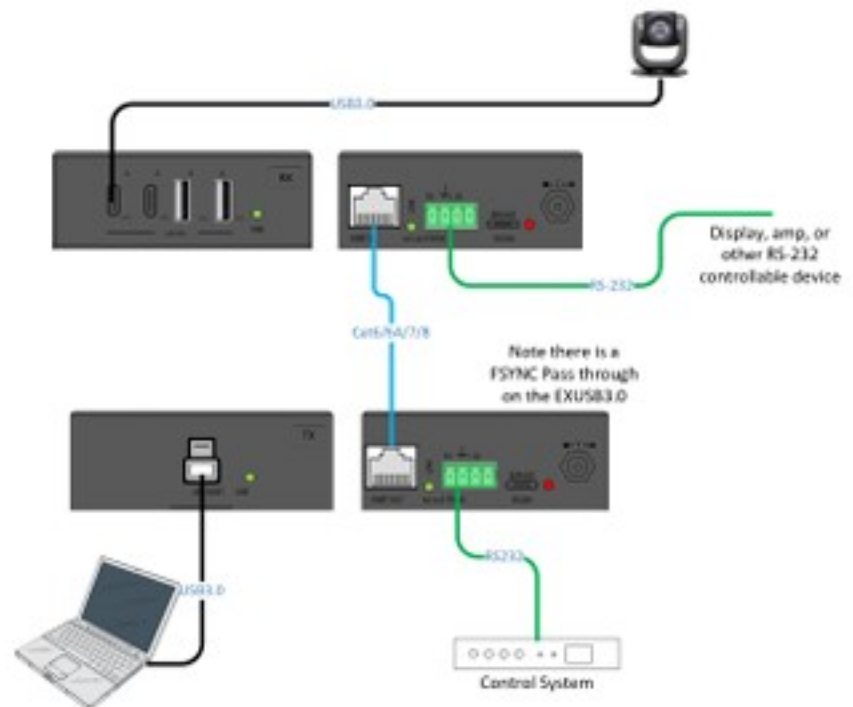

EXUSB3.0

USB 3.0/3.1/3.2 on category
Cable 100M Extender Kit
With FSYNC



Specifications:

Technical	
USB Compliance	USB 3.2,3.1,3.0, 2.0, 1.1
Bulk Data Transfer Rate	5 Gbps
FSYNC	Trigger for frame synchronization of multiple cameras
USB Ports	TX has single USB3.0 Type B port, RX has 4 Type A
USB Current	Two ports 1.5A, two ports 1.0A
Connections	
All Connections	<p>TX:</p> <ul style="list-style-type: none">1x USB 3.0 Type B1x RJ45 Cat out1x 4-Pin Phoenix Connector1x USB-C Connector1x Locking 5.5mm Power Connector <p>RX:</p> <ul style="list-style-type: none">2x USB -C (1 ea. 1.5A, & 1.0A)2 x USB Type A (1 ea. 1.5A, & 1.0A)1x RJ45 Cat in1x 4-Pin Phoenix Connector1x USB-C Connector1x Locking 5.5mm Power Connector
Mechanical	
Housing	Metal Enclosure
Color	Black
Dimensions	RX and TX are both 100mm/3.94" [W] x 80mm/3.15" [D] x 30mm/.118" [H]
Weight	TX 253g /8.92oz RX 260g /9.17oz.
Power Supply	Input: AC100 - 240V 50/60Hz Output: DC 24V/2A (US/EU standards, CE/FCC/UL certified)
Power Consumption	40W (Max)
Operating Temperature	32 - 104°F / 0 - 40°C
Storage Temperature	-4 - 140°F / -20 - 60°C
Relative Humidity	20 - 90% RH (no condensation)