

eARCEX

eARC Audio Extender with CEC

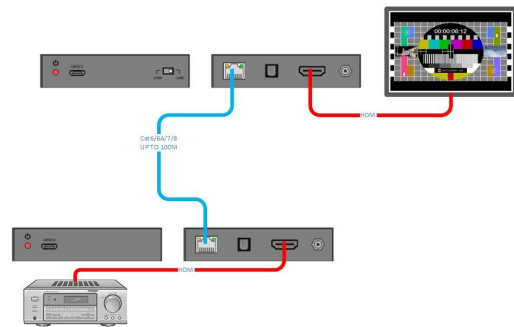

The eARCEX is an audio only extender designed to take the eARC audio of a display to an amplifier or other eARC/ARC enabled device and transmit it in full bandwidth up to 100m (330ft) over category cable. CEC transmission is supported so the display's remote can be used to control the volume of the amplifier/AVR. The eARCEX also supports optical S/PDIF transmission up to 100m. The eARCEX is designed to be a simple plug and play device to get eARC/ARC from the display back to the eARC/ARC enabled amplifier or other eARC/ARC device that is too far away to use a traditional HDMI cable.

Features:

- Supports all eARC audio formats
- Backwards compatible with ARC
- CEC source control
- Supports full uncompressed audio resolution
- Powers via single supply (either end)
- 3-Year Warranty

SIMPLIFIED
MFG

Specifications:

Technical	
Distance	100m/328ft.
eARC Formats	PCM 2.0/5.1/7.1ch, DD, DD+, DTS, Dolby TrueHD, DTS-HD MA, Dolby Atmos
ARC/SPDIF Formats	PCM 2.0CH, Dolby 5.1CH, DTS 5.1CH
ESD Protection	Human body model — ±8kV (air-gap discharge) & ±4kV (contact discharge)
Connections	
TX	Inputs: 1x HDMI (Type-A) 1x Optical (Toslink) 1x Micro USB (power) Outputs: 1x RJ-45
RX	Inputs: 1x RJ-45 1x Micro USB (power) Outputs: 1x HDMI (ARC) 1x Optical (Toslink)
Mechanical	
Housing	Metal Enclosure
Dimensions	90mm / 3.54" [W] x 72mm / 2.825" [D] x 20mm / .79" [H] 2.72"x2.5"x0.95"
Weight	TX or RX 184g/6.5oz. Ea.
Power Supply	Input: AC100 - 240V 50/60Hz Output: DC 5V/1A (US/EU standards, CE/FCC/UL certified)
Power Consumption	5.6W Max
Operation Temperature	32 - 104°F / 0 - 40°C
Storage Temperature	-4 - 140°F / -20 - 60°C
Relative Humidity	20 - 90% RH (no condensation)